

TrueNAS® Mini 3.0 Family Basic Setup Guide

Version 3.1



Contents

Introduction	1
1 Become Familiar with the TrueNAS Mini Family	2
1.1 The TrueNAS Mini E and E+	2
1.2 The TrueNAS Mini X	3
1.3 The TrueNAS Mini X+	4
1.4 The TrueNAS Mini XL+	5
2 Installing Hard Drives	6
3 Removing Drive Trays	7
4 Mini 2.5" Drive Bays	7
4.1 Mini XL+ 2.5" Bay Installation	7
4.2 Mini X/X+ 2.5" Bay Installation	8
5 Connect Network and Power Cables	9
5.1 Powering on the TrueNAS Mini	9
5.2 Console Setup on the TrueNAS Mini	9
6 Logging in to the TrueNAS Web Interface	10
7 Additional Resources	11
7.1 Contacting iXsystems	11

Copyright © 2020 iXsystems, Inc. All rights reserved. All trademarks are the property of their respective owners.

TrueNAS units are carefully packed and shipped with trusted carriers to arrive in perfect condition. If there is any shipping damage or any parts are missing, please take photos and contact iXsystems support immediately at support@ixsystems.com or 855-GREP4-iX (855-473-7449) or 408-943-4100.

Please locate and record the hardware serial numbers on the back of each chassis for quick reference.

Introduction

The TrueNAS Mini Storage Appliance is built to support all the features of TrueNAS in various convenient form factors. The Mini E and E+ have four hot-swappable 3.5" drive bays. The Mini X and X+ have five hot-swappable 3.5" drive bays and two 2.5" drive bays. The Mini XL+ has eight hot-swappable 3.5" drive bays and a single 2.5" drive bay.

TrueNAS Mini products share similar chassis and front panels, but have different system components that can change what type of connections are available and where they are located. Each Mini product has images that show where indicators and connectors are on that product. The warranty is not affected by removing or cutting the Tamper Resistant sticker to remove the case.

From left to right are the TrueNAS Mini E/E+, the TrueNAS Mini X/X+, and the TrueNAS Mini XL+ :



The drive bay door can be locked for added security. To lock the door, insert one of the door keys in the lock and turn the key clockwise ninety degrees.



1 Become Familiar with the TrueNAS Mini Family

1.1 The TrueNAS Mini E and E+

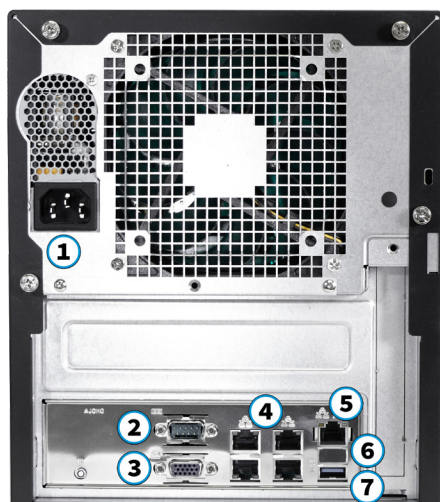
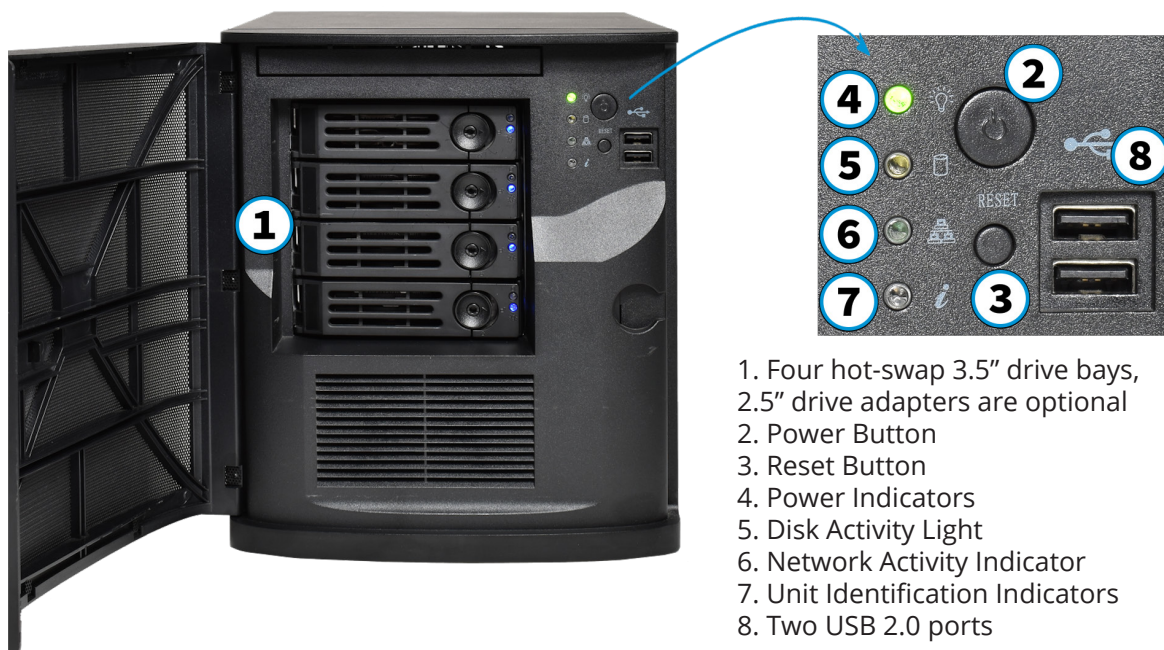

1. Back Panel Power Connector
2. Serial Port
3. VGA connector
4. Four GbE network ports
5. IPMI remote management network port
6. Port cover
7. One USB 3.0 port

The warranty is not affected by removing or cutting the *Tamper Resistant* sticker to remove the case.



1. Four 3.5" drive trays
2. Two Ethernet cables
3. One bag of HDD screws
4. One power cord
5. One set of keys

1.2 The TrueNAS Mini X

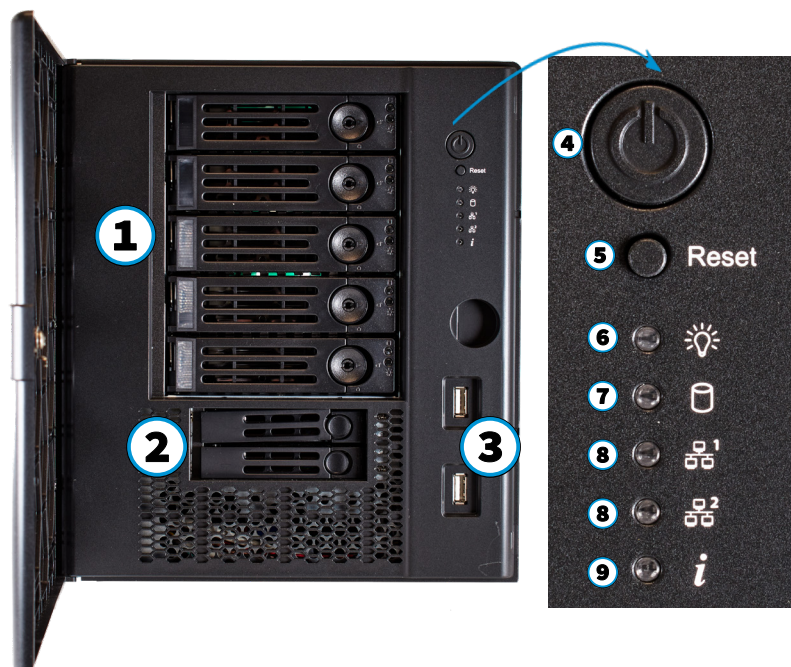

1. Five hot-swap 3.5" drive bays, 2.5" drive adapters are optional.
2. Two 2.5" drive bays
3. Two USB 2.0 ports
4. Power Button
5. Reset Button
6. Power Indicators
7. Disk Activity Light
8. Network Activity Indicator
9. Unit Identification Indicators

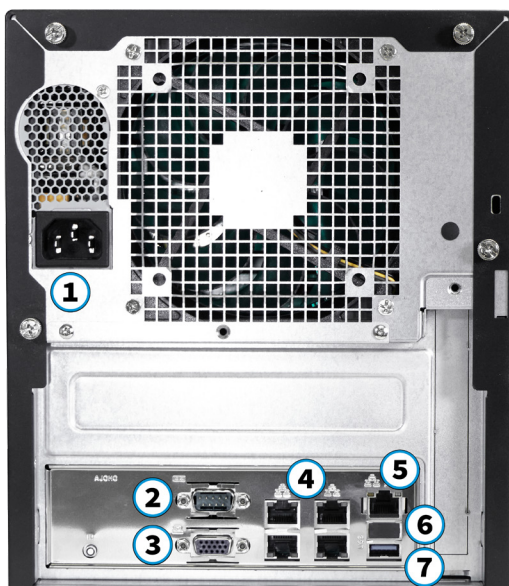

1. Back Panel Power Connector
2. Serial Port
3. VGA connector
4. Four GbE network ports
5. IPMI remote management network port
6. Port cover
7. One USB 3.0 port

The warranty is not affected by removing or cutting the *Tamper Resistant* sticker to remove the case.



1. Five 3.5" drive trays
2. Two 2.5" drive trays and screws
3. Two Ethernet cables
4. One bag of 3.5" HDD screws
5. One power cord
6. One set of keys

1.3 The TrueNAS Mini X+

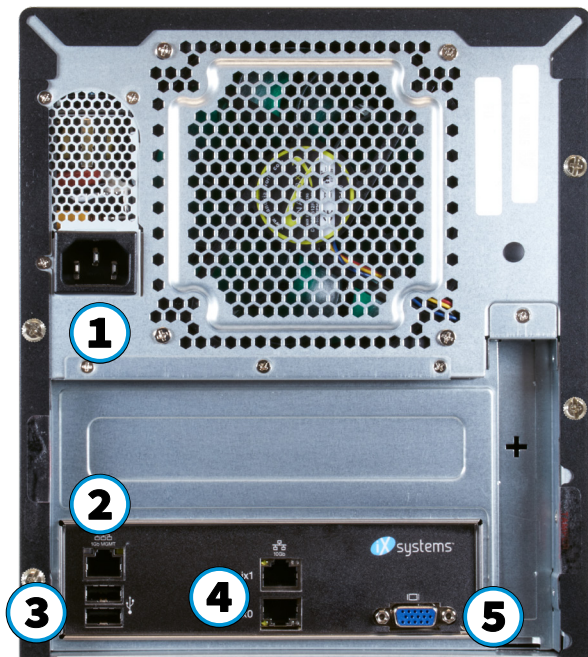
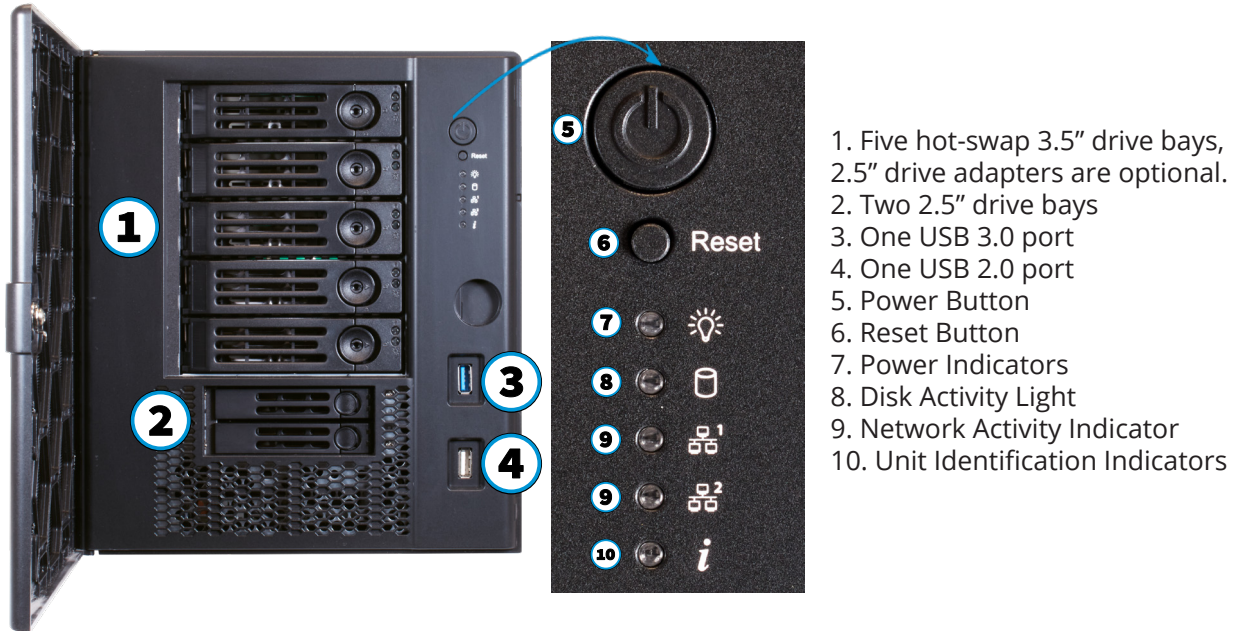

1. Back Panel Power Connector
2. IPMI remote management network port
3. Two USB 2.0 ports
4. Two 10 GbE network ports
5. VGA connector

The warranty is not affected by removing or cutting the *Tamper Resistant* sticker to remove the case.



1. Five 3.5" drive trays
2. Two 2.5" drive trays and screws
3. Two Ethernet cables
4. One bag of 3.5" HDD screws
5. One power cord
6. One set of keys

1.4 The TrueNAS Mini XL+



1. Eight 3.5" drive bays, 2.5" drive adapters are optional
2. One 2.5" drive bay
3. Power Button
4. Reset Button
5. Power Indicators
6. Disk Activity Light
7. Network Activity Indicator
8. Unit Identification Indicators
9. One USB 3.0 port
10. One USB 2.0 port



1. Back Panel Power Connector
2. IPMI remote management network port
3. Two USB 2.0 ports
4. Two 10 GbE network ports
5. VGA connector



1. Eight 3.5" drive trays
2. One 2.5" drive tray and screws
3. Two Ethernet cables
4. One bag of 3.5" HDD screws
5. One power cord
6. One set of keys

The warranty is not affected by removing or cutting the *Tamper Resistant* sticker to remove the case.

2 Installing Hard Drives

TrueNAS Minis support hard drives up to 14 TiB. Drives designed for Network Attached Storage (NAS) are required. These drives run cooler and quieter than desktop drives. NAS hard drives are available direct from iXsystems or retailers.

When ordered without hard drives, drive trays are shipped with filler inserts to protect them. If not all bays will be filled with drives, keep the fillers in the empty trays to protect them.

To mount a hard drive in a tray, remove the two rear screws holding the filler (1). Gently spread both sides of the tray away from the filler (2) until the pins release (3), then remove the filler.

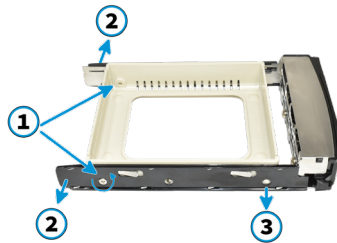

Place the hard drive into the tray (1) and mount the hard drive in the tray with four screws (2).

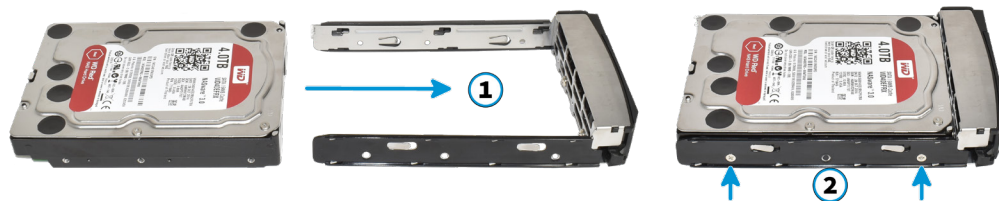

Starting with the top bay, gently insert a tray into a drive bay until it stops (1). Swing the latch closed until it locks (2). Repeat for all hard drives to be mounted. Load trays with fillers into any remaining empty bays.



Drive tray buttons can be locked to prevent tray removal. The tray button is unlocked when the slot is horizontal and locked when the slot is vertical. Lock a tray button by inserting a flat-head screwdriver into the slot in the center of the button and gently turn it ninety degrees clockwise so the slot is vertical.

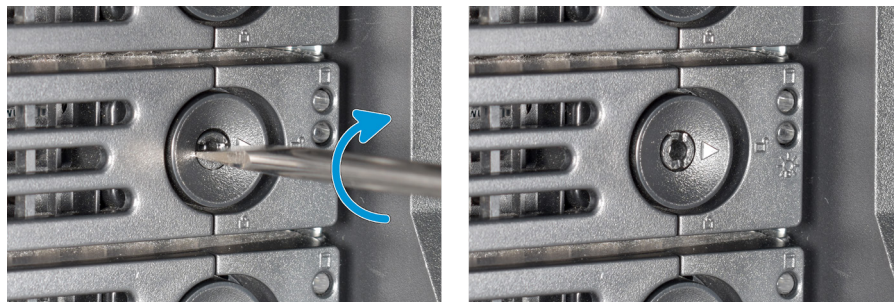

3 Removing Drive Trays

If a drive tray must be removed, release the latch by pushing the large circular button to the right (1). Swing the latch to the left to eject the tray, then pull outwards on the latch to begin sliding the tray out (2). Grip the top and bottom of the tray and gently remove it (3).



4 Mini 2.5" Drive Bays

4.1 Mini XL+ 2.5" Bay Installation

The Mini XL+ has a single additional 2.5" bay for an SSD.

To remove the tray, release the latch by sliding the button to the left (1). Gently swing the latch to the right (2), then slide the tray out (3).



To add an SSD, unscrew the two attachment screws from the SSD tray underside and remove the SSD tray filler (4). Attach the SSD to the tray with four screws from the bag labeled 2.5" through the bottom of the tray (5).

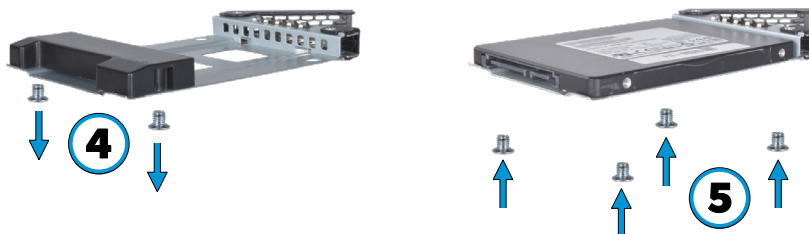

Gently insert the tray into the bay until it stops (6) and the latch is nearly shut. Swing the latch closed until it locks (7).



4.2 Mini X/X+ 2.5" Bay Installation

The Mini X and X+ have two 2.5" sdd drive bays.

To remove the tray, release the latch by sliding the button to the left (1). Gently swing the latch to the right (2), then slide the tray out (3). Remove the filler tray from the drive tray by removing the screws (4), place the drive in the tray and secure the drive to the tray with the provided screws (5).

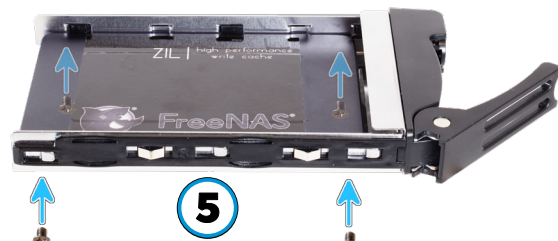
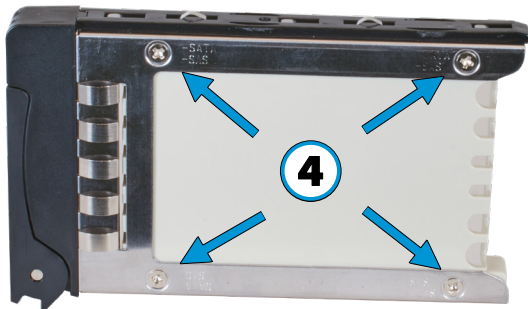
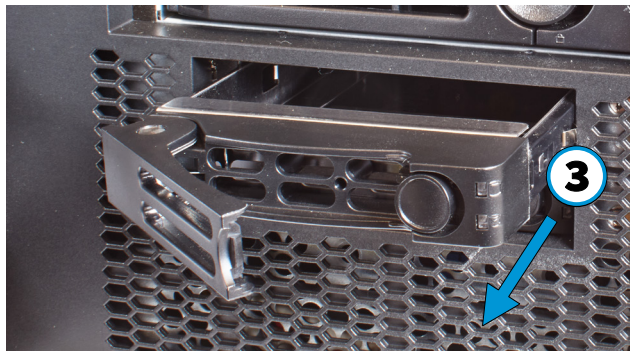
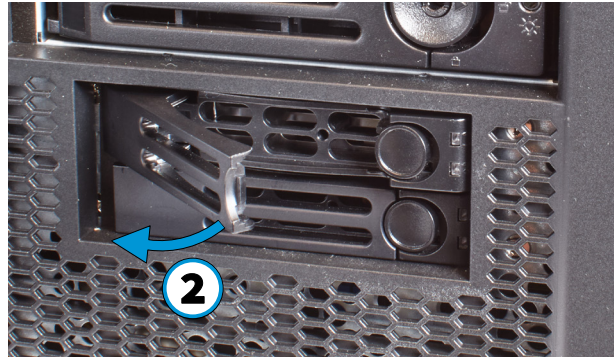

Follow the same process for both drive trays. To reinsert the tray in the unit, follow the inverse of the removal steps. Gently insert the tray into the bay until it stops (6) and the latch is nearly shut. Swing the latch closed until it locks (7).



5 Connect Network and Power Cables

Connect the network cable to the router or switch and to a gigabit networking port. Plug the power cable into the TrueNAS Mini and a power outlet.



5.1 Powering on the TrueNAS Mini

The Power and Reset buttons control the power state of the TrueNAS Mini. These buttons behave in the same manner as standard PC power and reset buttons. When the system is off, pressing the power button will power on the system. Pressing and holding the power button while the system is running will perform a hard power off. The reset button will reboot the system.

5.2 Console Setup on the TrueNAS Mini

A VGA monitor and USB keyboard can be connected for console access, but are not required. If a monitor and keyboard is attached you will be presented with the CLI Console. For more details about the Console options, see the [Console Setup Menu help article](https://truenas.com/docs/) available from truenas.com/docs/.

If remote management through IPMI is desired, connect a network cable to the IPMI network port. See Section 1.1 *Become Familiar with the TrueNAS Mini Family* for port identification for the specific TrueNAS Model.

```
Console setup
-----

1) Configure Network Interfaces
2) Configure Link Aggregation
3) Configure VLAN Interface
4) Configure Default Route
5) Configure Static Routes
6) Configure DNS
7) Reset Root Password
8) Reset Configuration to Defaults
9) Shell
10) Reboot
11) Shut Down

The web user interface is at:

http://10.0.0.102

Enter an option from 1-11: █
```

6 Logging in to the TrueNAS Web Interface

TrueNAS uses the Multicast DNS service, also known as Bonjour or mDNS, to make the system accessible on most networks without additional setup.

Run a web browser on another computer on the same network. Open the TrueNAS web interface by typing `truenas.local` or the IP address of the TrueNAS Mini system into the browser address bar and pressing **Enter**.

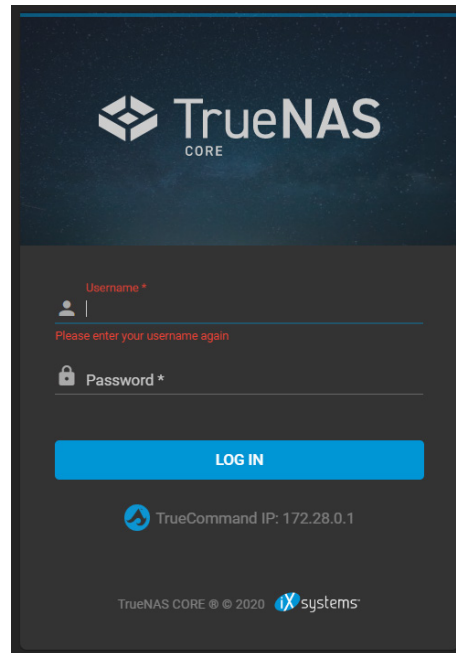

Log in with:

Username: **root**

Password: **abcd1234**

After logging in, you can change the **root** account password in *Account --> Users* to increase system security.

When more than one TrueNAS device is connected to the network, mDNS can experience name conflicts. Give each TrueNAS device a unique hostname like `truenas1.local` and `truenas2.local` to avoid this problem. The hostname is changed in *Network --> Global Configuration --> Hostname* in the TrueNAS web interface.

7 Additional Resources

The TrueNAS User Guide has complete software configuration and usage instructions. It is available by clicking Guide in the TrueNAS web interface or going directly to:

<https://www.ixsystems.com/documentation/truenas/>

Additional guides, datasheets, and knowledge base articles are available in the iX Information Library at:

<https://www.ixsystems.com/library/>

The TrueNAS forums provide an opportunity to interact with other TrueNAS users and to discuss their configurations. The forums are available at:

<https://ixsystems.com/community/forums/>

7.1 Contacting iXsystems

For assistance, please contact iX Support:

Contact Method	Contact Options
Web	https://support.ixsystems.com
Email	support@ixsystems.com
Telephone	Monday-Friday, 6:00AM to 6:00PM Pacific Standard Time: <ul style="list-style-type: none">• US-only toll-free: 855-473-7449 option 2• Local and international: 408-943-4100 option 2
Telephone	Telephone After Hours (24x7 Gold Level Support only): <ul style="list-style-type: none">• US-only toll-free: 855-499-5131• International: 408-878-3140 (International calling rates will apply)

